

# GasPro™

## TEM-737125

1.125" C-seal Sintered Nickel Media Surface Mount Sandwich Filter



GasPro™ TEM-737125 is a unique filter for surface mount gas delivery systems, designed to be placed under another component. Placing under a valve or regulator eliminates one substrate and effectively shortens the system and reduces its cost.

### Specifications

- **Filtration rating**  
Efficient 3 nm particle retention.
- **Maximum operating temperature**  
200°C (392°F) in inert gas
- **Maximum operating pressure**  
750 PSI at 250°F (51.7 bar at 121.1°C)

### Features

- **All welded sintered nickel media-316L stainless hardware**  
Good corrosion resistance; excellent bake-out characteristics for fast dry downs and in-line qualification.
- **Electro-polished 316L housing**  
The filter assemblies have a 10Ra electro-polished 316L stainless steel housing to prevent corrosion and particle formation.
- **Out of package cleanliness**  
Our GasPro™ TEM-737125 filters are cleaned and packaged in a cleanroom with organic free handling for out-of-package, particle free, and chemical free cleanliness. Final assembly is purged with filtered nitrogen for initial cleanliness. Additional preconditioning is optional.
- **100% helium leak tested to greater than 1x10<sup>-9</sup> atm cc/second**

### Specifications

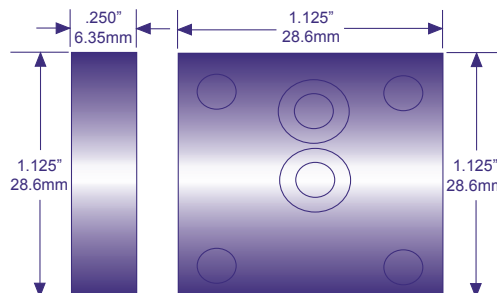

### Ni Media - Gas flow rate vs Pressure drop

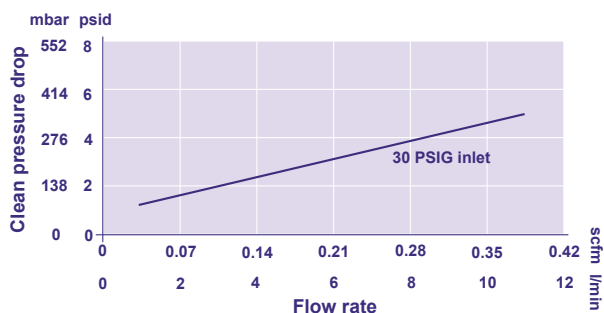

### Part Numbers and Ordering Information

Part number	Inlet/outlet fittings	Filter media/hardware
TEM-737125	1.125" C-Seal	Sintered Nickel / 316L